



Left Elevation facing Rugby Road  
1 : 200

for information only - do not scale off this drawing

FITZROY PRESBYTERIAN CHURCH,  
BELFAST  
PROPOSED ALTERATIONS TO CHURCH HALLS

2004-sk 20a  
scale 1-200  
29 Jan 2013

ARCHITECTS  
KNOX  
AND  
MARKWELL

# proposed ground floor plan

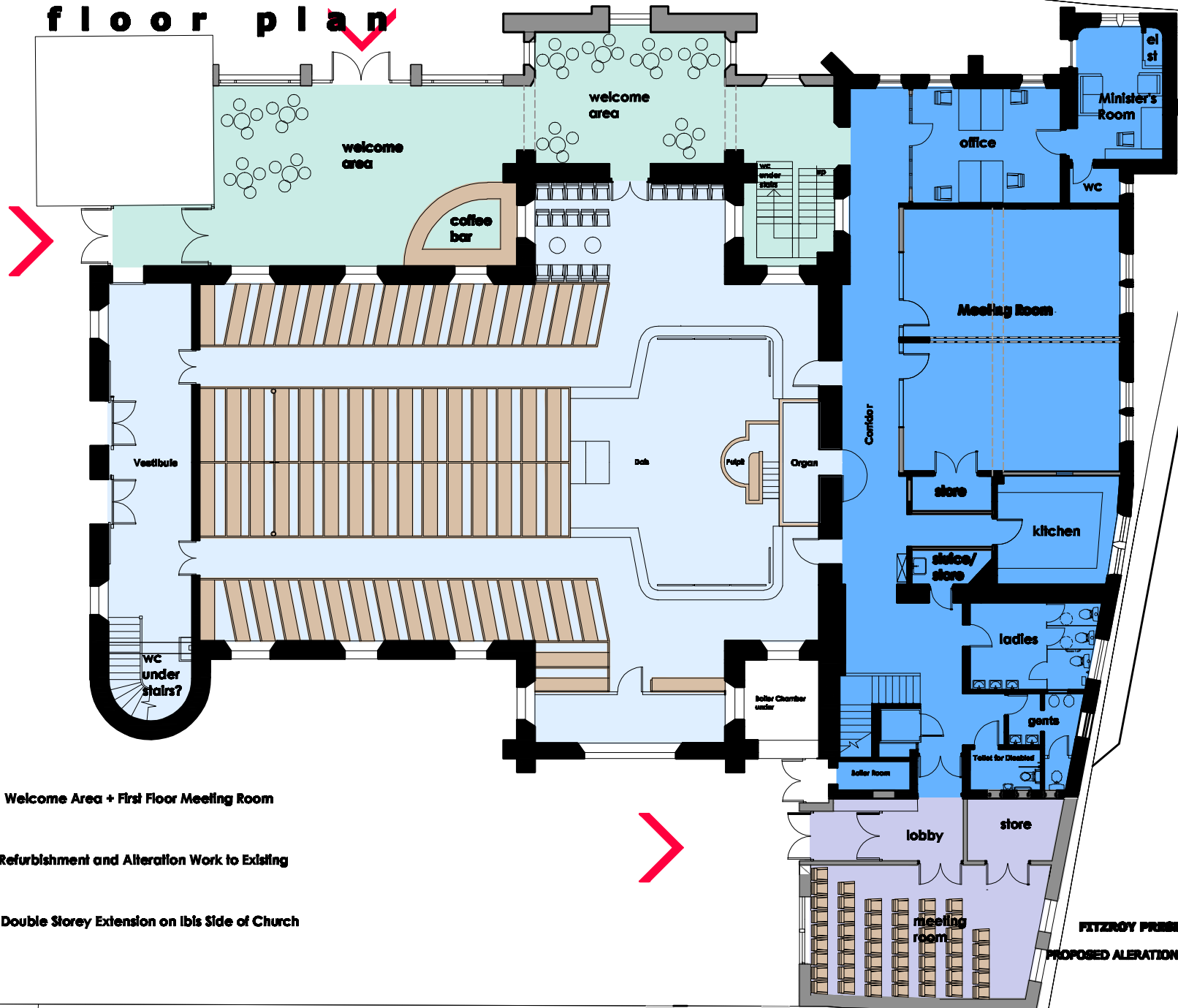



for information only - do not build off this drawing

**FITZROY PRESBYTERIAN CHURCH,  
BELFAST**  
**PROPOSED ALTERATIONS TO CHURCH HALLS**

2004-05-05  
scale 1:200  
May 2003

**ARCHITECTS**  
**KNOX**  
**AND**  
**MARKWELL**

# proposed first floor plan

-  A Welcome Area + First Floor Meeting Room
-  B Refurbishment and Alteration Work to Existing
-  C Double Storey Extension on Ibis Side of Church

